

REVOLUTIONARY EXTERIOR GLASS PARTITIONING SYSTEM



www.skyfold.com

Custom powerlift partitions

KEY FEATURES AND BENEFITS

Skyfold Mirage XT is an automatic glass partitioning system specifically designed for exterior use. It combines the efficiency and convenience of custom powerlift partitions with thermal acoustic glass that adds depth and elegance to any establishment.

Its quiet motor drive system discretely lifts the glass wall out of sight and into an overhead storage cavity in two to three minutes, allowing operators to adapt to changing weather conditions with minimal disruption. The customized system can be retrofitted to accommodate any existing structure and comes in a variety of glass and non-glass finishes.

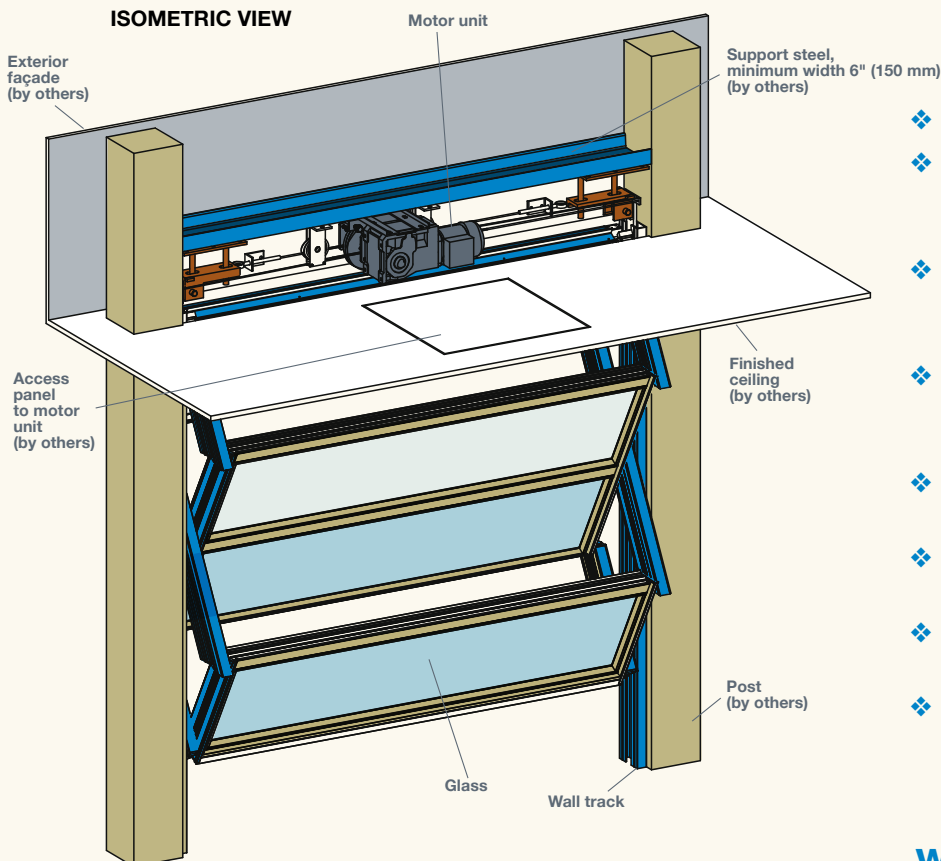

- ❖ Eye-catching, modern design.
- ❖ Acoustic glass wall lets natural light in while keeping outside noise to a minimum.
- ❖ Automatic, turnkey operation means partitions never need to be physically handled.
- ❖ Discreet, ceiling-mounted motor drive system keeps walls out of sight and out of the way when not required.
- ❖ Side seals feature automatic locking mechanisms for added security.
- ❖ All-weather thermal reflective glass reduces energy costs.
- ❖ Various glass options available including privacy glass.
- ❖ Will benefit projects requiring LEED certification.



SPECIFICATIONS

	CSA-440	ASTM Test Procedures	AAMA/NWWDA
AIR TIGHTNESS RATING	A2 1.16 (m ³ /h)/m	0.235 cfm/ft ² @ 1.57 psf	0.235 cfm/ft ² @ 1.57 psf
WATER TIGHTNESS RATING (without sill dam option)	B4 400 Pa	No water infiltration under a pressure differential of 8.35 psf (400 Pa)	DP 55
WATER TIGHTNESS RATING (with sill dam option)	B7 700 Pa	No water infiltration under a pressure differential of 15 psf (720 Pa)	DP 100
WIND LOAD RESISTANCE* (Panel ht up to 25 11/16", 652mm)	C3 3 kPa	negative and positive design load 42 psf (2010 Pa)	DP - 40
WIND LOAD RESISTANCE** (Panel ht up to 19", 483mm)	C5 5 kPa	negative and positive design load 70 psf (3352 Pa)	DP - 70
FORCED ENTRY	F20 (Grade 40)	Grade 40	Grade 40
Condensation Resistance***	I _g (glass index) =55.1 I _f (frame index) = 40.6 I = 40.6	-	C40
Standardized Thermal Transmittance (Ust)***	2.25 W/(m ² °C)	0.40 BTU/(hr•ft ² °F)	U40
Thermal Resistance (R)***	0.44 m ² °C/W	2.5 (hr•ft ² °F)/BTU	-

SP – Special Product designation under AAMA/WDMA/CSA 101/I.S.2/A440-05:
 * SP 40 - Tested Length 144" (3658mm)
 ** SP 70 - Tested length 77" (1956mm) with theoretical length limit of 132" (3454mm)

***TESTED LAMINATED GLASS SPECIFICATION:

1/8" (3mm) clear annealed glass + 0.030" (0.8mm) film (72% Solar transmittance, 88% light transmittance and 0.77 Solar heat gain) + 1/8" (3mm) clear annealed glass + 9/16" (15mm) aluminum spacer with a capillary tube to release pressure and air as the gas between the panes + 1/8" (3mm) clear annealed glass + 0.030" (0.8mm) film + 1/8" (3mm) clear annealed glass.

Overall Glass Thickness:
 1 1/8" (28.6mm)

* DP – Design Pressure CSA – Canadian Standards Association ASTM - American Society for Testing and Materials
 AAMA – American Architectural Manufacturers Association NWWDA – National Wood Window and Door Association

Custom powerlift partitions

www.skyfold.com



Part of the Railtech Architectural Group

For more information visit our website or contact us directly:

MAIN OFFICE
 T 514 457-4767 F 514 457-7111 info@skyfold.com
 325 Lee Avenue, Montreal, Quebec CANADA H9X 3S3